

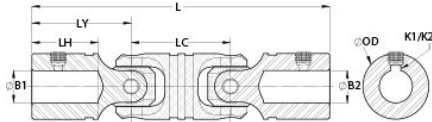

UDSK24-12-12-F

Ruland UDSK24-12-12-F, 3/4" x 3/4" Double Universal Joint, Friction Bearing, Steel, Set Screw With Keyway, 1.495" OD, 6.563" Length



Description

Ruland UDSK24-12-12-F is a double cardan friction bearing universal joint with 0.7500" x 0.7500" bores, 3/16" x 3/16" keyways, 1.495" OD, 6.563" length, and 5/16-18 set screws. It is ideal for applications with wide distances between shafts and can accommodate all forms of misalignment. This plain bearing double universal joint is comprised of pins and blocks that are precision machined, selectively heat treated, and ground for high strength, accuracy, and wear resistance. The combination of these components with precision ground and hardened yoke ears allow for a longer lifespan, increased performance in demanding applications, and greater angular misalignment of up to 90° when compared to commodity style double universal joints. UDSK24-12-12-F is made from high grade alloy steel for durability and high strength. It can be combined with boot UBOOT24/38-NI-KIT to protect the joints from unwanted contaminants such as dust or water and self lubricate reducing maintenance time. This double cardan universal joint is manufactured in the USA by Belden Universal for strict control of processes.

Product Specifications

Bore (B1)	0.7500 in	Small Bore (B2)	0.7500 in
Keyway (K1)	3/16 in	Keyway (K2)	3/16 in
B1 Max Shaft Penetration	1.400 in	B2 Max Shaft Penetration	1.400 in
Joint Outer Diameter (OD)	1.495 in	Bore Tolerance	+0.0010 in / -0.0000 in
Length (L)	6.563 in	Center Yoke Length (LC)	2.313 in
Yoke Length (LY)	2.125 in	Hub Depth (LH)	1.400 in
Broached Set Screw	5/16-18	Screw Material	Alloy Steel
Screw Finish	Black Oxide	Peak Torque	9000 in-lb
Rated Torque	1,800 in-lb	Max Operating Angle	90°
Material Specification	Alloy Steel	Manufacturer	Belden Universal
Country of Origin	USA	Weight (lbs)	2.318000
Recommended Lubricant	LUBRIPLATE No. 1200-2	Matching Boot Cover	UBOOT24/38-NI-KIT
UPC	634529289204	Tariff Code	8483.60.4000
UNSPC	25173810		

Note 1 Performance ratings are for guidance only. The user must determine suitability for a particular application.

Prop 65  **WARNING** This product can expose you to the chemical Ethylene Thiourea, known to the State of California to cause cancer and birth defects or other reproductive harm. For more information go to www.P65Warnings.ca.gov.