

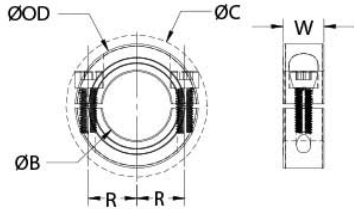

## MSP-48E-SS

Ruland MSP-48E-SS, 3" International Shaft Collar, 303 Stainless Steel, Two-Piece Clamp Style, 108mm OD, 19mm Width



### Description

Ruland MSP-48E-SS is a two-piece shaft collar with a 3.0000" bore, 108mm OD, and 19mm width. It is an international series shaft collar that has metric hardware and dimensions with inch bores. The clamp style design does not mar the shaft, is easy to remove, and is indefinitely adjustable. MSP-48E-SS is commonly used for guiding, spacing, stopping, mounting, and component alignment. Equipment manufacturers benefit from the tightly controlled face to bore perpendicularity of Ruland shaft collars, TIR of  $\pm 0.05$ mm. Perpendicularity is critical for alignment when the shaft collar is used as a load bearing face, mechanical stop, or for mounting components such as gears or bearings. Proprietary processes have been developed by Ruland to maintain superior fit, finish, and holding power. MSP-48E-SS is stamped with the Ruland name and bore size for ease of identification. Halves are mated throughout the manufacturing process for proper fit and alignment. Forged screws test beyond DIN 912 12.9 standards to ensure maximum holding power. MSP-48E-SS is manufactured from solid bar stock sourced from select North American mills and machined to a fine burr free finish. Ruland uses 303 stainless steel with hardware of like material for consistent corrosion resistance. Stainless steel hardware undergoes a proprietary surface treatment process to prevent galling. MSP-48E-SS is RoHS3 and REACH compliant and manufactured in our Marlborough, MA factory under strict controls using proprietary processes.

### Product Specifications

<b>Bore (B1)</b>	3.0000 in	<b>Bore Tolerance</b>	+0.0020 in / +0.0005 in
<b>Outer Diameter (OD)</b>	108 mm	<b>Clearance Diameter (C) MAX</b>	113.8 mm
<b>Width (W)</b>	19 mm	<b>Width Tolerance</b>	+0.076 mm / -0.254 mm
<b>Recommended Gap</b>	3.18 mm	<b>Recommended Shaft Tolerance</b>	+0.0000 in / -0.0010 in
<b>Forged Clamp Screw</b>	M8	<b>Screw Material</b>	18-8 300 Series Stainless Steel
<b>Hex Wrench Size</b>	6.0 mm	<b>Screw Finish</b>	Bright
<b>Seating Torque</b>	23 Nm	<b>Screw Location (R)</b>	46.99 mm
<b>Number of Screws</b>	2 ea	<b>Material Specification</b>	Type 303 Austenitic, Non-Magnetic Bar
<b>Finish Specification</b>	Bright, No Plating	<b>Manufacturer</b>	Ruland Manufacturing
<b>Country of Origin</b>	USA	<b>Temperature</b>	-40°F to 350°F (-40°C to 176°C)
<b>Weight (lbs)</b>	1.419500	<b>UPC</b>	634529118184
<b>Tariff Code</b>	8483.60.8000	<b>UNSPC</b>	31162811
<b>Note 1</b>	Performance ratings are for guidance only. The user must determine suitability for a particular application.		
<b>Prop 65</b>	 <b>WARNING</b> This product can expose you to the chemical Nickel (metallic), known to the State of California to cause cancer. For more information go to <a href="http://www.P65Warnings.ca.gov">www.P65Warnings.ca.gov</a> .		

### Installation Instructions

1. Use the MSP-48E-SS international series shaft collar as it is received.
2. Wipe the bore clean.
3. Apply a thin coat of light oil to the shaft.
4. Place the collar onto the desired shaft location and tighten it using a 6.0 mm hex wrench until a slight resistance is felt.
5. Be sure to maintain the gap of 3.18 mm between the two halves of the collar during installation.
6. Wring collar into its final position and tighten the screw to the full recommended seating torque of 23 Nm using a 6.0 mm torque wrench.