

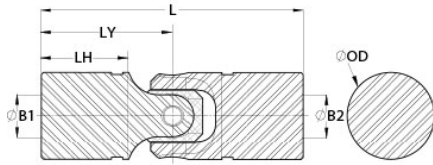

## US12-XX-XX-F

Ruland US12-XX-XX-F, Machinable Bore Single Universal Joint, Friction Bearing, Steel, 0.745" (18.9mm) OD, 2.688" (68.3mm) Length



### Description

Ruland US12-XX-XX-F is a single cardan friction bearing universal joint with friction bores that can be machined with a bore size and geometry of the user's choice. It has a 0.745" (18.9mm) OD and 2.688" (68.3mm) length. US12-XX-XX-F is ideal for applications with space constraints and has higher torque capacity than equivalently sized double universal joints. This plain bearing universal joint is comprised of pins and blocks that are precision machined, selectively heat treated, and ground for high strength, accuracy, and wear resistance. The combination of these components with precision ground and hardened yoke ears allow for a longer lifespan, increased performance in demanding applications, and greater angular misalignment of up to 45° when compared to commodity style single universal joints. US12-XX-XX-F is made from high grade alloy steel for durability and high strength. It can be combined with boot UBOOT12/19-NI-KIT to protect the joint from unwanted contaminants such as dust or water and self lubricate reducing maintenance time. This single cardan universal joint is manufactured in the USA by Belden Universal for strict control of processes.

### Product Specifications

<b>Bore (B1)</b>	No Bore	<b>Small Bore (B2)</b>	No Bore
<b>B1 Max Shaft Penetration</b>	0.950 in (24.1 mm)	<b>B2 Max Shaft Penetration</b>	0.950 in (24.1 mm)
<b>Joint Outer Diameter (OD)</b>	0.745 in (18.9 mm)	<b>Length (L)</b>	2.688 in (68.3 mm)
<b>Yoke Length (LY)</b>	1.344 in (34.1 mm)	<b>Hub Depth (LH)</b>	0.950 in (24.1 mm)
<b>Max Round Bore (Inch)</b>	0.4531 in	<b>Max Round Bore (Metric)</b>	11 mm
<b>Max Hex or Square Bore (Inch)</b>	0.4375 in	<b>Max Hex or Square Bore (Metric)</b>	10 mm
<b>Max Blind Bore (Inch)</b>	0.6250 in	<b>Max Blind Bore (Metric)</b>	15 mm
<b>Max Round Bore w/ Key (Inch)</b>	7/16" Bore, 3/32" Keyway	<b>Max Round Bore w/ Key (Metric)</b>	12mm Bore, 4mm Keyway
<b>Peak Torque</b>	1250 in-lb (141.2 Nm)	<b>Rated Torque</b>	250 in-lb (28.2 Nm)
<b>Max Operating Angle</b>	45°	<b>Material Specification</b>	Alloy Steel
<b>Manufacturer</b>	Belden Universal	<b>Country of Origin</b>	USA
<b>Weight (lbs)</b>	0.286000	<b>Recommended Lubricant</b>	LUBRIPLATE No. 1200-2
<b>Matching Boot Cover</b>	<a href="#">UBOOT12/19-NI-KIT</a>	<b>UPC</b>	634529289532
<b>Tariff Code</b>	8483.60.4000	<b>UNSPC</b>	25173810

**Note 1** Performance ratings are for guidance only. The user must determine suitability for a particular application.

**Prop 65**  **WARNING** This product can expose you to the chemical Ethylene Thiourea, known to the State of California to cause cancer and birth defects or other reproductive harm. For more information go to [www.P65Warnings.ca.gov](http://www.P65Warnings.ca.gov).