

HC-STA-B24-BWSC-ELC-AL - Housing



1411330
<https://www.phoenixcontact.com/us/products/1411330>

Please be informed that the data shown in this PDF document is generated from our online catalog. Please find the complete data in the user documentation. Our general terms of use for downloads are valid.



Panel mounting base B24, with single locking latch, material: Die-cast aluminum, salt water resistant, protective cover material: PC, height: 30.5 mm, cable gland: none, protective cover: yes, Standard, with flat gasket

Your advantages

- Good shielding in the event of electromagnetic interference

Commercial data

Item number	1411330
Packing unit	1 pc
Minimum order quantity	1 pc
Sales key	BF56
Product key	BF7APB
Catalog page	Page 633 (C-2-2019)
GTIN	4046356927505
Weight per piece (including packing)	174 g
Weight per piece (excluding packing)	175 g
Customs tariff number	85389099
Country of origin	CN

HC-STA-B24-BWSC-ELC-AL - Housing



1411330

<https://www.phoenixcontact.com/us/products/1411330>

Technical data

Notes

General	For contact inserts HC-B24, BB46, D64, DD108, M
General	also available as a powder-coated or color version: 1373281 HC-STA-B24-BWSC-EL/.../...

Product properties

Product type	Housing with locking latch
Housing type	Panel mounting base
Application	Standard
Type	B24
Protective cover	yes
Pg screw connection	none

Data management status

Article revision	05
------------------	----

Dimensions

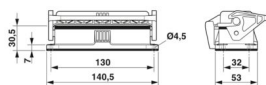
Dimensional drawing	
Width	53 mm
Height	30.5 mm
Length	140.5 mm
Drill hole distance, horizontal	130 mm
Drill hole distance, vertical	32 mm
Hole diameter	4.5 mm

Installation dimensions

Width of the assembly cutout	35 mm
Length of the assembly cutout	113 mm

Material specifications

Flammability rating according to UL 94	V0 (Interlock)
	V0 (Protective cover)
Seal material	NBR, conductive
	NBR, conductive
Housing material	Die-cast aluminum, salt water resistant
Housing surface material	uncoated
Material, protective cover	PC
Locking latch material	PA

Mechanical properties

HC-STA-B24-BWSC-ELC-AL - Housing



1411330

<https://www.phoenixcontact.com/us/products/1411330>

Mechanical data

Locking type	Latch
--------------	-------

Connection data

Tightening torque	0.8 Nm ... 1.2 Nm (For M4 mounting screws on the panel-mount base)
-------------------	--------------------------------------------------------------------

Environmental and real-life conditions

Ambient conditions

Degree of protection	IP66 (with locked protective cover)
	IP67 (when plugged in)
Impact strength	IK08
Ambient temperature (operation)	-40 °C ... 125 °C

HC-STA-B24-BWSC-ELC-AL - Housing

1411330

<https://www.phoenixcontact.com/us/products/1411330>



Drawings

Dimensional drawing

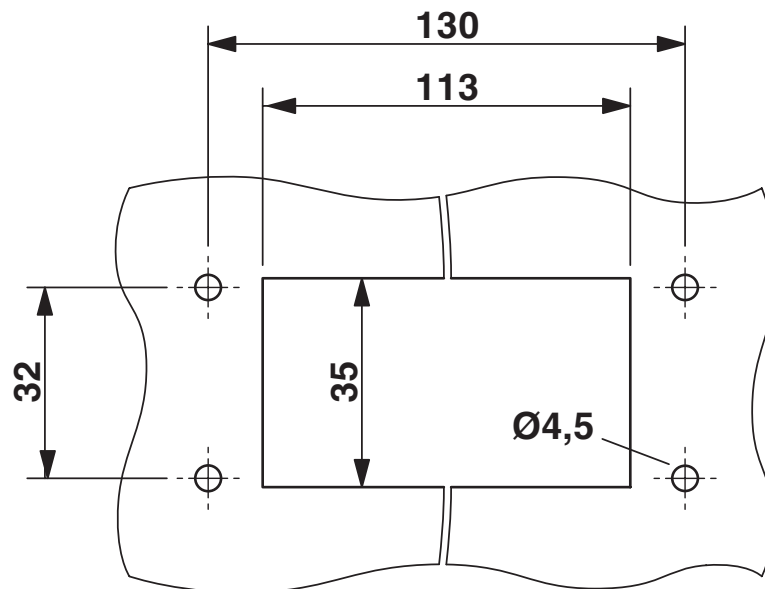

Mounting cutout

Dimensional drawing

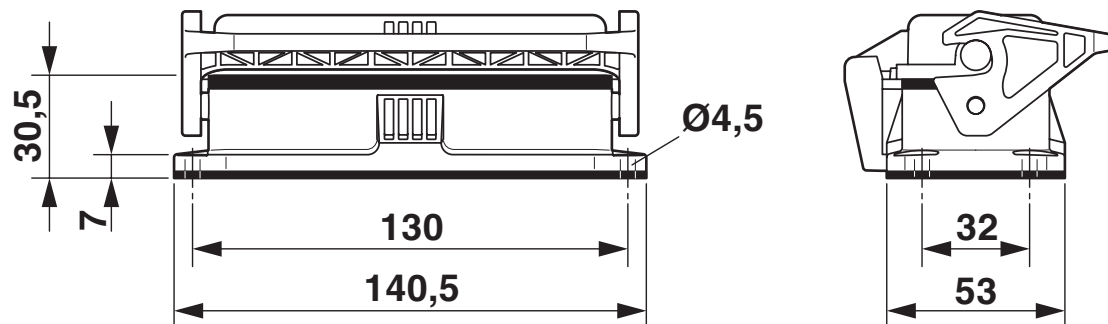

Dimensional drawing

HC-STA-B24-BWSC-ELC-AL - Housing



1411330

<https://www.phoenixcontact.com/us/products/1411330>

Approvals

To download certificates, visit the product detail page: <https://www.phoenixcontact.com/us/products/1411330>

DNV

Approval ID: TAE000037S



EAC

Approval ID: RU C-DE.AI30.B.01102



EAC

Approval ID: RU C-DE.AI30.B.01102



EAC

Approval ID: RU C-DE.BL08.B.00511



EAC

Approval ID: RU C-DE.BL08.B.00511

DNV

Approval ID: TAE000037S



cUL Recognized

Approval ID: E255026



UL Recognized

Approval ID: E255026

cULus Recognized

HC-STA-B24-BWSC-ELC-AL - Housing



1411330

<https://www.phoenixcontact.com/us/products/1411330>

Classifications

ECLASS

ECLASS-11.0	27440202
ECLASS-12.0	27440202
ECLASS-13.0	27440202

ETIM

ETIM 9.0	EC000437
----------	----------

UNSPSC

UNSPSC 21.0	31261500
-------------	----------

Environmental product compliance

EU RoHS	
Fulfills EU RoHS substance requirements	Yes, No exemptions
China RoHS	
Environment friendly use period (EFUP)	EFUP-E
	No hazardous substances above the limits
EU REACH SVHC	
REACH candidate substance (CAS No.)	No substance above 0.1 wt%

HC-STA-B24-BWSC-ELC-AL - Housing



1411330

<https://www.phoenixcontact.com/us/products/1411330>

Accessories

HC-B24-SG-CBK - Flat gasket

1411486

<https://www.phoenixcontact.com/us/products/1411486>

Replacement flat gasket, for HEAVYCON panel mounting base, HC-STA....AL, type B24, conductive



HC-B24-SP-CBK - Profile gasket

1411482

<https://www.phoenixcontact.com/us/products/1411482>

Profile gasket for HEAVYCON EVO supporting base element type B24, conductive



HC-STA-B24-BWSC-ELC-AL - Housing

1411330

<https://www.phoenixcontact.com/us/products/1411330>



HC-STA-B24-SL-PLBK - Housing brackets

1412885

<https://www.phoenixcontact.com/us/products/1412885>



Single locking latch for B24 housing, HC-EVO....AL and HC-STA....AL

HC-B24-BC-HI-PLBK - Protective cover

1407695

<https://www.phoenixcontact.com/us/products/1407695>



Protective cover B24, for single locking latch, protective cover material: PC, height: 19 mm, seal: no

HC-STA-B24-BWSC-ELC-AL - Housing

1411330

<https://www.phoenixcontact.com/us/products/1411330>



US-EMLP-HA (20X9) - Plastic label

0830989

<https://www.phoenixcontact.com/us/products/0830989>



Plastic label, Card, white, unlabeled, can be labeled with: BLUEMARK ID COLOR, BLUEMARK ID, THERMOMARK PRIME, THERMOMARK CARD 2.0, THERMOMARK CARD, mounting type: adhesive, lettering field size: 20 x 9 mm, Number of individual labels: 70

US-EMLP-HA (20X9) CUS - Plastic label

0830995

<https://www.phoenixcontact.com/us/products/0830995>



Plastic label, Card, can be ordered: by card, white, labeled, can be labeled with: THERMOMARK CARD, mounting type: adhesive, lettering field size: 20 x 9 mm, Number of individual labels: 70

HC-STA-B24-BWSC-ELC-AL - Housing

1411330

<https://www.phoenixcontact.com/us/products/1411330>



HC-STA-B24-DC-PL - Protective cover

1421103

<https://www.phoenixcontact.com/us/products/1421103>



Protective cover, design: B24

Phoenix Contact 2024 © - all rights reserved

<https://www.phoenixcontact.com>

Phoenix Contact USA
586 Fulling Mill Road
Middletown, PA 17057, United States
(+717) 944-1300
info@phoenixcon.com