

CAV. NO. (A, B..)

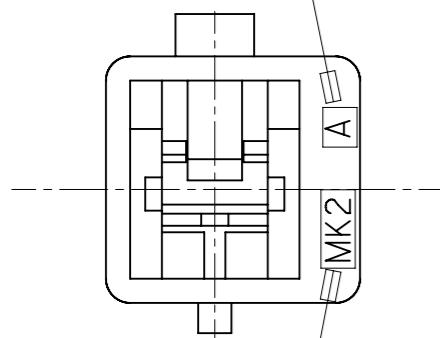

TRADE MARK
(MK2)

NOTES

1. MATERIAL & COLOR : SEE TABLE
2. MATING HOUSING: 35151-0110
3. APPLICABLE TERMINAL: 35745-0*10
4. APPLICABLE TPA: 35182-019*

NO	PRODUCT		MATERIAL	
	PART NO	MATERIAL NO	COLOR	DESCRIPTION
1	35150-0100	351500100	NATURAL	PBT (UL94V-0)
2	35150-0109	351500109	NATURAL	PBT/PC

THIS DRAWING CONTAINS INFORMATION THAT IS PROPRIETARY TO MOLEX ELECTRONIC TECHNOLOGIES, LLC AND SHOULD NOT BE USED WITHOUT WRITTEN PERMISSION		CURRENT REV DESC: OBSOLETE PART NUMBER		molex	
DIMENSION UNITS: mm		SCALE: 4:1			
GENERAL TOLERANCES (UNLESS SPECIFIED)				.070 W/W RECEPTACLE HSG-1P	
				PRODUCT CUSTOMER DRAWING	
EC NO: 644856				DOCUMENT NUMBER	
DRWN: RPRABHUM				SD-35150-0100	
CHK'D: GGA				DOC TYPE: PSD	
APPR: GGA				DOC PART: 001	
INITIAL REVISION:				REVISION: D	
DRWN: WY.YANG					
APPR: CW.LEE					
DRAFT WHERE APPLICABLE MUST REMAIN WITHIN DIMENSIONS		THIRD ANGLE PROJECTION		SHEET NUMBER	
		DRAWING: A3-SIZE		1 OF 1	
		SERIES: 35150			
		MATERIAL NUMBER: SEE TABLE		CUSTOMER: GENERAL MARKET	