

### Surface Mount Termination 16 Watts, 50Ω



#### Description

The C16A50Z4 is high performance Alumina ( $Al_2O_3$ ) surface mount termination intended as a cost competitive alternative to Aluminum Nitride (AlN). The termination is well suited to all cellular frequency bands such as; AMPS, GSM, DCS, PCS, PHS and UMTS. The high power handling makes the part ideal for terminating high power 90 degree couplers and for use in microstrip circuits. The termination is also RoHS compliant!

#### Features:

- RoHS Compliant
- 16 Watts
- DC – 4.0 GHz
- $Al_2O_3$  Ceramic
- Non-Nichrome Resistive Element
- Low Return Loss
- 100% Tested
- Small Size

#### General Specifications

<b>Resistive Element</b>	Thick film
<b>Substrate</b>	$Al_2O_3$ Ceramic
<b>Terminal Finish</b>	Matte Tin over Nickel Barrier
<b>Operating Temperature</b>	-50 to +125°C (see de rating chart)

Tolerance is  $\pm 0.010"$ , unless otherwise specified. Designed to meet or exceed applicable portions of MIL-E-5400. **All dimensions in inches.**

#### Electrical Specifications

<b>Resistance Value:</b>	50 Ohms, $\pm 2\%$
<b>Power:</b>	16 Watts
<b>Frequency Range:</b>	DC – 4.0 GHz
<b>Return Loss</b>	>26 dB DC - 2.7 GHz >24 dB DC - 4.0 GHz

Specification based on unit properly installed using suggested mounting instructions and a 50 ohm nominal impedance. **Specifications subject to change.**

#### Outline Drawing

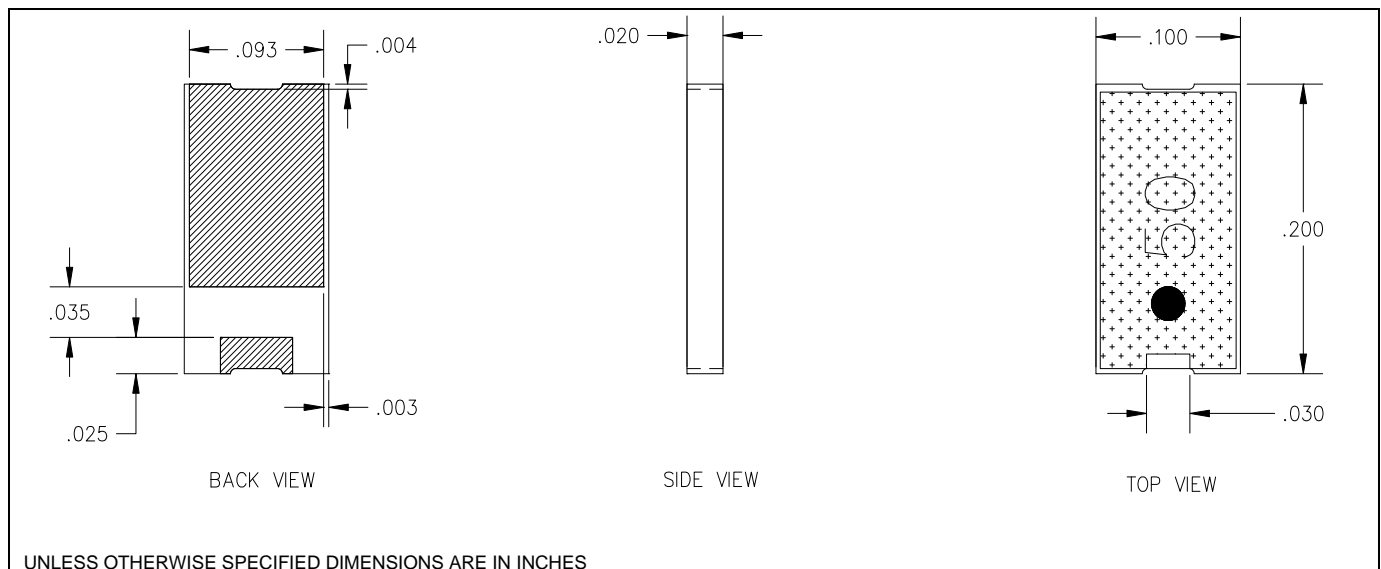

### Typical Performance:

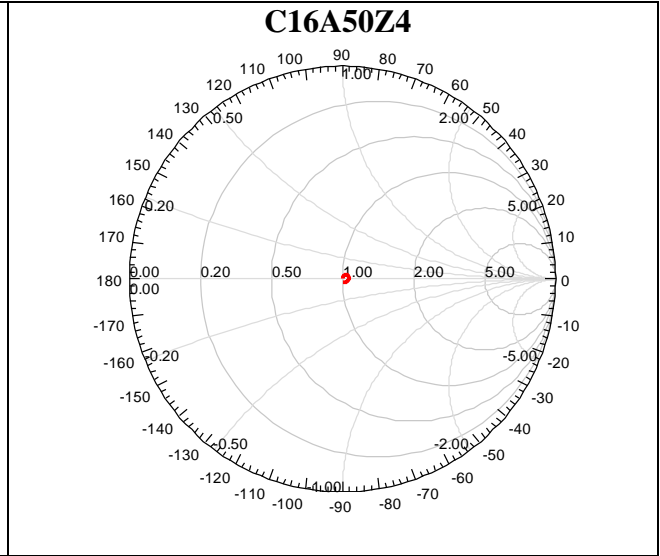
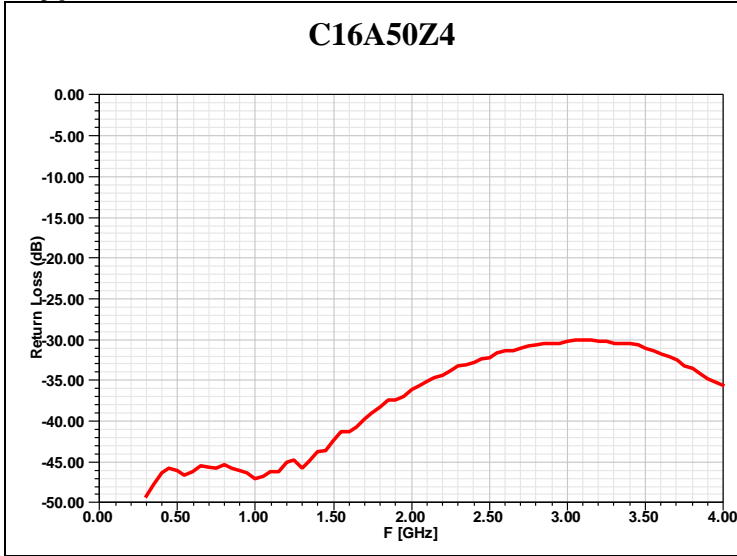

### Power De-rating:

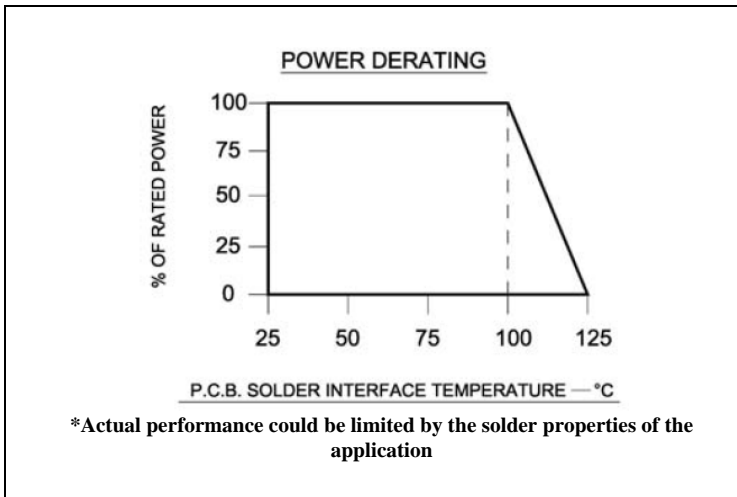

### Mounting Footprint and Procedure:

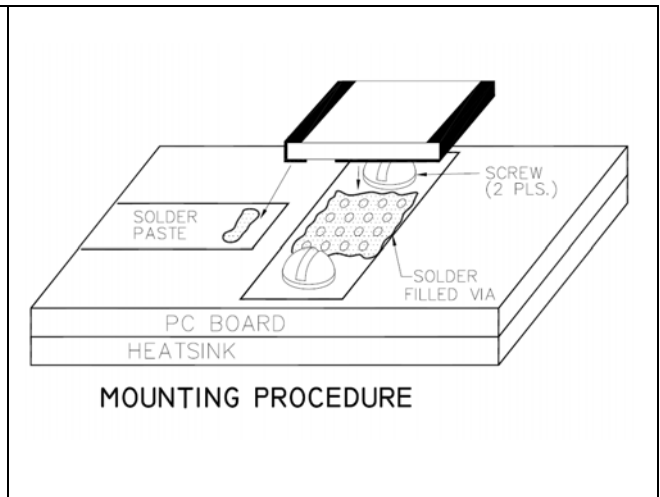

### Tape & Reel:

