

## SPECIFICATIONS:

## ELECTRICAL:

INSULATOR RESISTANCE:	5 G OHMS Min.
DIELECTRIC WITHSTANDING:	1,000VAC r.m.s.
OPERATING TEMPERATURE:	-55° C ~ +125° C
POWER CONTACT RESISTANCE:	1.0 mOHMS Max.
SIGNAL CONTACT RESISTANCE:	2.7 mOHMS Max.
POWER PINS:	SEE PART NUMBER BELOW
SIGNAL PINS:	5 AMPS

## MECHANICAL:

CONTACT INSERTION FORCE:	4.5 Kg Max.
CONTACT SEPARATOR FORCE:	0.3Kg Min.

## MATERIALS:

CONTACTS:	COPPER ALLOY
INSULATOR:	PBT UL94V-0 RATED, BLK
	230°C PROCESS TEMP.
SHELL:	STEEL

## FINISH:

SHELL:	NICKEL
CONTACTS:	FULL GOLD FLASH

680M7W2103LYY1

2 = 20 AMP  
4 = 40 AMP

0 = NO HARDWARE  
1 = 0.098" CN SOLDER SIDE  
2 = 0.236" CN SOLDER SIDE  
3 = 0.236" CN MATING SIDE

1 = GOLD FLASH  
\*CONTACT NORCOMP FOR MORE OPTIONS

RoHS COMPLIANT

UNITS = inch [mm]

DO NOT SCALE FROM DRAWING



THESE DRAWINGS AND SPECIFICATIONS ARE THE PROPERTY OF NorComp AND SHALL NOT BE REPRODUCED, COPIED OR USED AS THE BASIS FOR THE MANUFACTURE OR SALE OF APPARATUS WITHOUT WRITTEN PERMISSION.

DRAWN:  
P. JENKINS

DATE:  
08/22/2011

NorComp

SCALE:  
NTS

SHEET 1 OF 2

REV  
3

DWG NO.

680M7W2103LYY1

## HARDWARE OPTIONS

### CLINCH NUTS HAVE #4-40 INTERNAL THREADS THRU

0 ..... NO HARDWARE

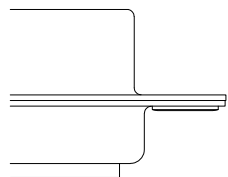

1 ..... 0.098" SOLDER SIDE

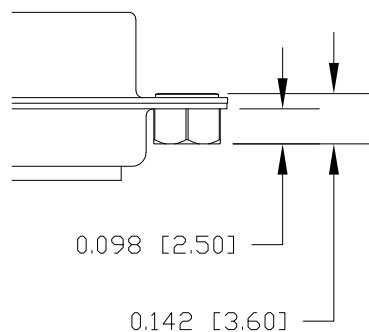

2 ..... 0.236" SOLDER SIDE

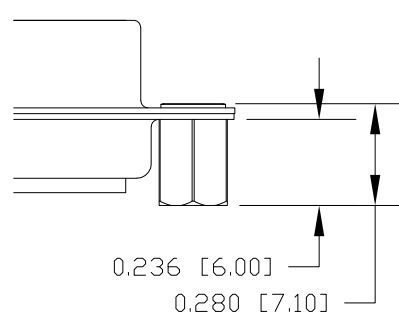

3 ..... 0.236" MATING SIDE

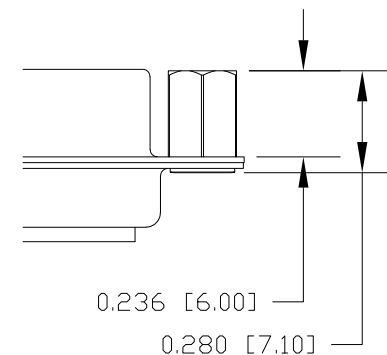

**NOTE:**  
SIGNAL AND POWER CONTACTS  
COME PRE-LOADED INTO INSULATORS

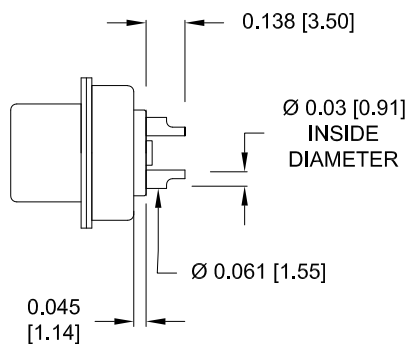

SIGNAL CONTACTS  
ACCEPTS UP TO 20 AWG WIRE

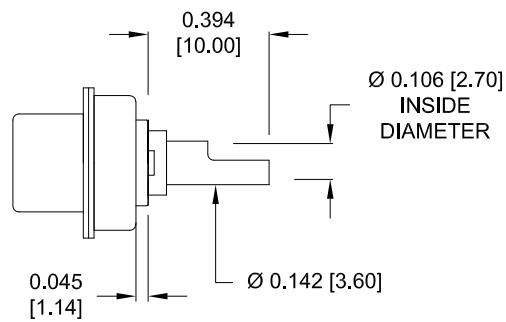

20 AMP POWER CONTACTS  
ACCEPTS UP TO 12 AWG WIRE

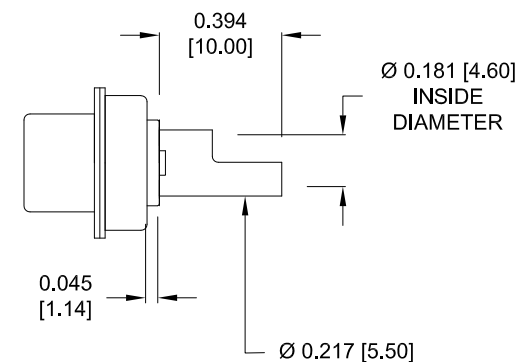

40 AMP POWER CONTACTS  
ACCEPTS UP TO 8 AWG WIRE

RoHS COMPLIANT

UNITS = inch [mm]

DO NOT SCALE FROM DRAWING



THESE DRAWINGS AND SPECIFICATIONS ARE THE PROPERTY OF NorComp AND SHALL NOT BE REPRODUCED, COPIED OR USED AS THE BASIS FOR THE MANUFACTURE OR SALE OF APPARATUS WITHOUT WRITTEN PERMISSION.

DRAWN:  
**P. JENKINS**

DATE:  
**08/22/2011**

# NorComp

SCALE:  
**NTS**

SHEET **2** OF **2**

REV  
**3**

DWG NO.

## 680M7W2103LYY1