

NPB 568

Switchcraft®

RMAS8 & RMAS8PRO

Dual Transformer Isolated Audio Splitters

FEATURES:

- 8 input, 24 output dual transformer isolated audio splitter.
- 8 Switchcraft® front panel XLR inputs.
- Line level pad on each channel.
- Two ground lift toggle switches on each channel (1 for each transformer isolated output).
- 4 DB25 connectors (TASCAM pinout) to accommodate all of the units I/O's.
- Additional set of I/O connections utilizing Euro style terminal blocks (RMAS8PRO Only).
- JENSEN magnetically shielded (MU Metal) dual isolated audio transformers (RMAS8PRO Only).

RMAS8



RMAS8PRO



New from Switchcraft®...

The RMAS8 and RMAS8PRO are 8 input, 24 output (3-way) dual transformer isolated audio splitters. Both units feature 8 Switchcraft® XLR front panel inputs, each with a line level pad and two ground lift toggle switches (1 for each transformer isolated output). On the back, 4 DB25 connectors wired to the TASCAM DTRS standard pinout can be used to accommodate all of the units I/O's. Additionally, the RMAS8PRO features JENSEN magnetically shielded (MU Metal) dual isolated audio transformers and has a third set of Euro style terminal blocks.

For more information, visit:

www.switchcraft.com/products/pdf_files/audio_splitters.pdf

Switchcraft®
www.switchcraft.com
5555 N. Elston Avenue/Chicago, IL 60630
Phone: 773-792-2700 Fax: 773-792-2129

RMAS8 & RMAS8PRO Dual Transformer Isolated Audio Splitters

RMAS8



RMAS8PRO



Switchcraft®

RMA8 3-Way Audio Splitter

The RMA8 is an 8 input, 24 output dual transformer isolated audio splitter. It features 8 Switchcraft® XLR inputs on the front, each with a line level pad and two ground lift toggle switches (1 for each transformer isolated output). On the back, 4 DB25 connectors wired to the TASCAM DTRS standard pinout can be used to accommodate all of the units I/O's.

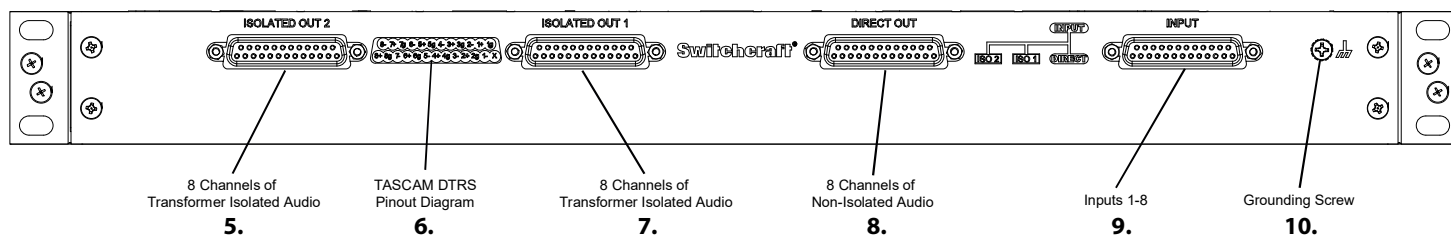
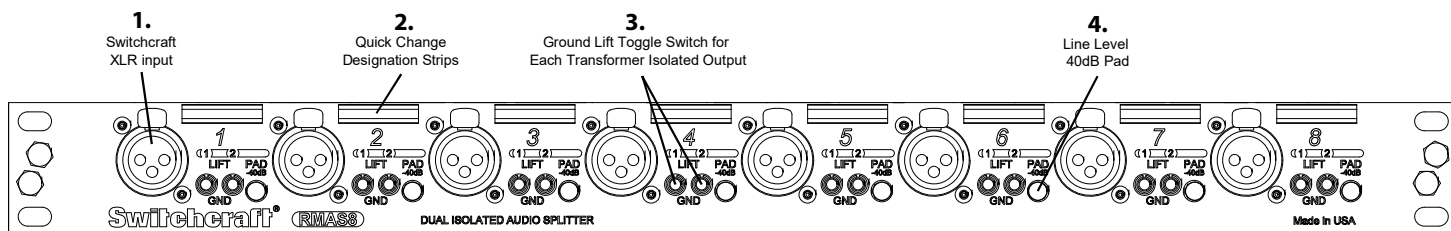

1. Premium grade Switchcraft® XLR inputs for front panel connection of individual audio signals.
2. Quick change designation strips are used to create and modify custom channel labeling for each input.
3. High quality toggle switches allow you to connect or isolate (lift) the ground connection for either of each channel's transformer isolated outputs.
4. Line level (40dB) pad switch (for isolated outputs only) helps prevent transformer saturation from line level signals.
5. Second set of eight transformer isolated audio outputs.
6. TASCAM DTRS pinout diagram for all DB25 inputs and outputs.
7. First set of eight transformer isolated audio outputs.
8. Eight direct outputs with grounds permanently connected. It is necessary to use this output for powering phantom powered microphones.
9. DB25 inputs 1-8. These can be used instead of, but not along with the front panel XLR inputs.
10. Chassis ground connection point.

Switchcraft®
www.switchcraft.com
 5555 N. Elston Avenue/Chicago, IL 60630
 Phone: 773-792-2700 Fax: 773-792-2129

Switchcraft®

RMAS8PRO 3-Way Audio Splitter

The RMAS8PRO is an 8 input, 24 output dual transformer isolated audio splitter. It features 8 Switchcraft® XLR inputs on the front, each with a line level pad and two ground lift toggle switches (1 for each transformer isolated output). On the back, 4 DB25 connectors wired to the TASCAM DTRS pinout can be used to accommodate all of the units I/O's. Additionally, the RMAS8PRO features JENSEN magnetically shielded (MU Metal) dual isolated audio transformers and has a third set of Euro style terminal block I/O's.

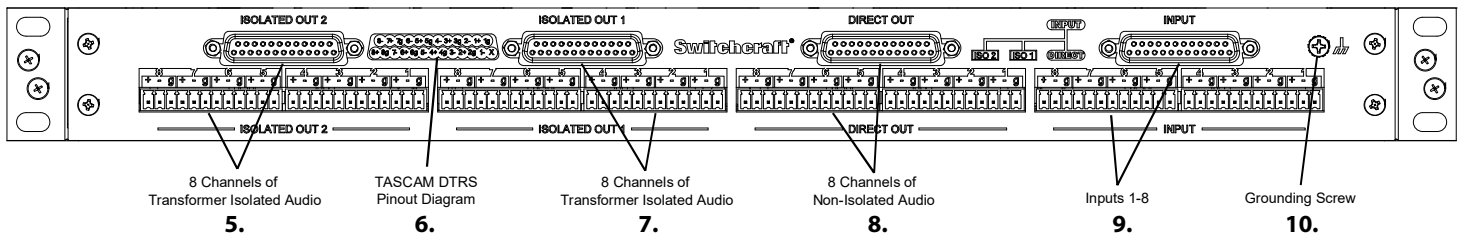
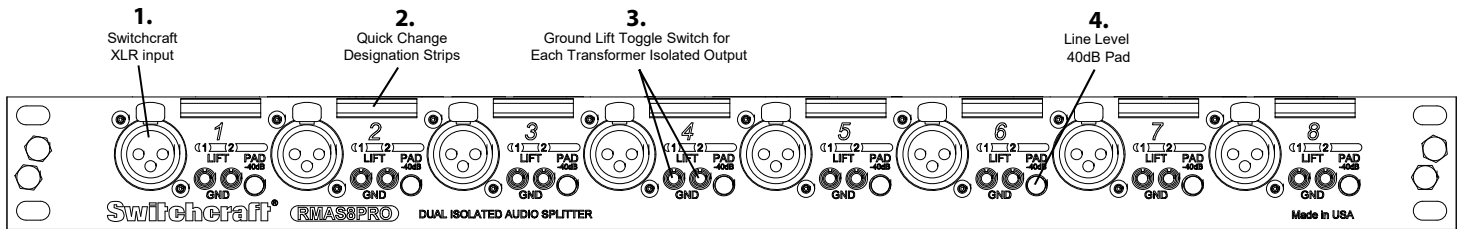

1. Premium grade Switchcraft® XLR inputs for front panel connection of individual audio signals.
2. Quick change designation strips are used to create and modify custom channel labeling for each input.
3. High quality toggle switches allow you to connect or isolate the ground connection for either of each channel's transformer isolated outputs.
4. Line level (40dB) pad switch (for isolated outputs only) helps prevent transformer saturation from line level signals.
5. Second set of eight transformer isolated audio outputs.
6. TASCAM DTRS pinout diagram for all DB25 inputs and outputs.
7. First set of eight transformer isolated audio outputs.
8. Eight direct outputs with grounds permanently connected. It is necessary to use this output for powering phantom powered microphones.
9. DB25/Euro block inputs 1-8. Either the DB25 or Euro block inputs can be used instead of, but not along with the front panel XLR inputs.
10. Chassis ground connection point.

Switchcraft®
www.switchcraft.com
 5555 N. Elston Avenue/Chicago, IL 60630
 Phone: 773-792-2700 Fax: 773-792-2129