

9	8	7	6	5	4	3	2	1
PART NUMBER	DESCRIPTION			MATERIAL			AGENCY APPROVAL	
180414-0102	COB LED HOLDER 13.5MM X 13.5MM			POLYAMIDE (PA66) GLASS FILLED, COLOR: NATURAL			UL496 FILE E345583	
180414-0112	COB LED HOLDER 13.5MM X 13.5MM			POLYESTER (PBT) GLASS FILLED, COLOR: WHITE			UL496 FILE E345583	

HOLDER ASSEMBLY
180414-0102, 180414-0112

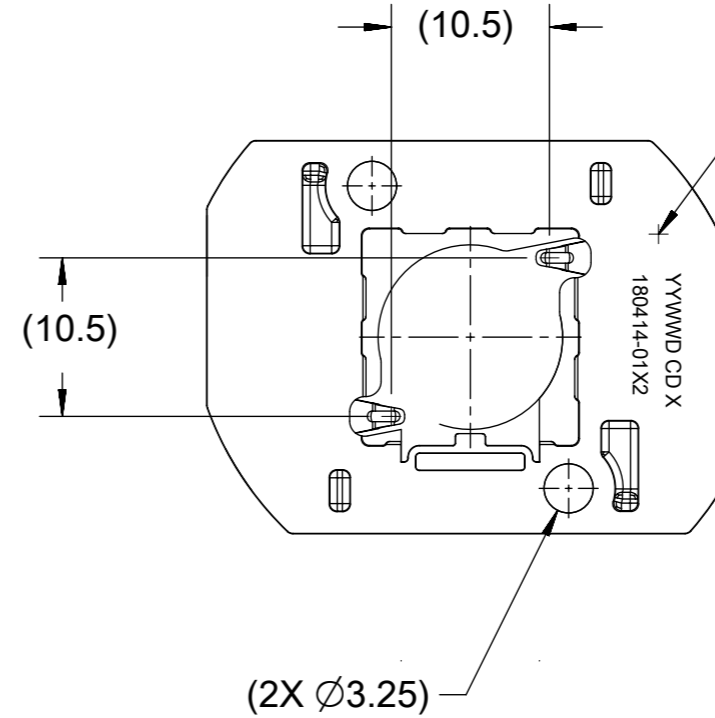
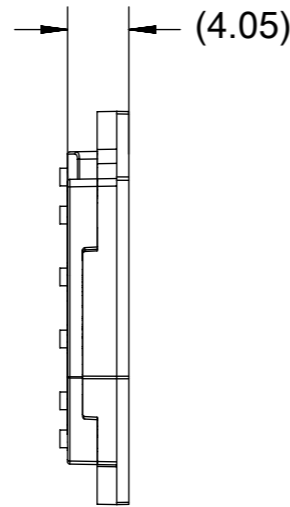
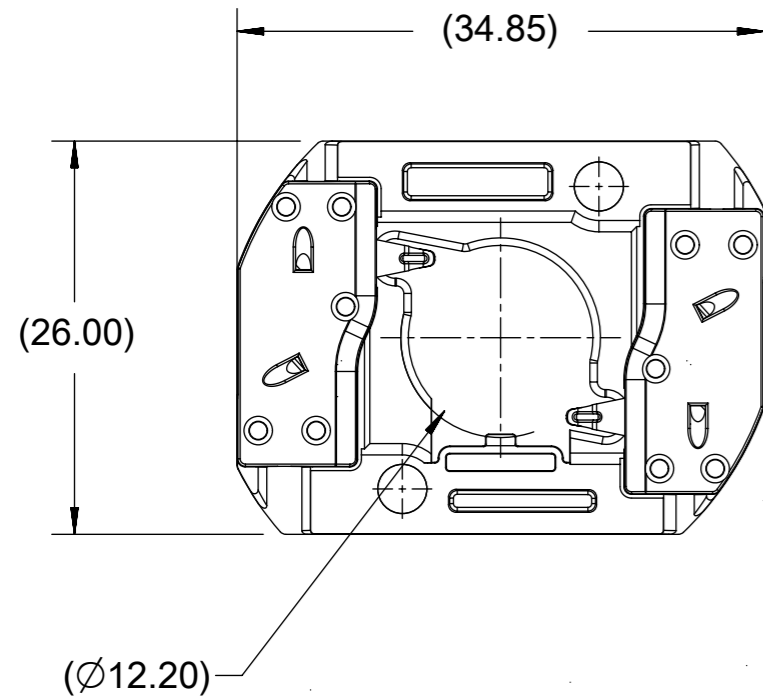

PART MARKED WITH
DATE CODE (YYWWD)
MFG PLANT (CD)
REVISION (X)
PART NUMBER (180414-01X2)

YYWWD CD X
180414-01X2

NOTES:

1. MATERIALS: HOUSING AND CAPS: SEE CHART, TERMINAL: COPPER ALLOY
2. FINISHES: TERMINAL: NICKEL (Ni) UNDERPLATE 1.27 µm, WIRE TRAP SELECT TIN (Sn) 2.54µm, LED CONTACT SELECT GOLD (Au) 0.76µm
3. PRODUCT SPECIFICATION: PS-180414-001
4. PACKAGING SPECIFICATION: PK-180419-005
5. SEE CHART FOR AGENCY APPROVAL INFORMATION
6. ELV AND ROHS COMPLIANT.
7. SEE SHEET 3 FOR APPLICATION NOTES.

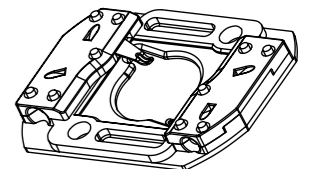

ISO VIEW 1
SCALE 1:1

THIS DRAWING CONTAINS INFORMATION THAT IS PROPRIETARY TO MOLEX ELECTRONIC TECHNOLOGIES, LLC AND SHOULD NOT BE USED WITHOUT WRITTEN PERMISSION										
DIMENSION UNITS	SCALE	CURRENT REV DESC:								
mm	1:1									
GENERAL TOLERANCES (UNLESS SPECIFIED)		EC NO: 624787			COB LED HOLDER ASSEMBLY 13.5MM X 13.5MM SQUARE					
ANGULAR TOL	± 0.5°	DRWN: VLOKESHA 2019/05/21			PRODUCT CUSTOMER DRAWING					
4 PLACES	±	CHK'D: GGA 2019/11/11			DOCUMENT NUMBER					
3 PLACES	±	APPR: GGA 2019/11/11			SD-180414-102			DOC TYPE	DOC PART	REVISION
2 PLACES	± 0.13	INITIAL REVISION:			PSD 001 C4					
1 PLACE	± 0.25	DRWN: MCOLE 2012/05/24			MATERIAL NUMBER					
0 PLACES	±	APPR: DMCGOWAN 2012/08/06			CUSTOMER					
DRAFT WHERE APPLICABLE MUST REMAIN WITHIN DIMENSIONS		THIRD ANGLE PROJECTION	DRAWING	SERIES	SEE TABLE		GENERAL MARKET		SHEET NUMBER	
			A3-SIZE	180414					1 OF 2	

DOCUMENT STATUS	P1	RELEASE DATE	2019/11/11	02:35:53
-----------------	----	--------------	------------	----------

COB MFG	TYPE	DIM 'X'	DIM 'Y'	DIM 'Z'	DIM 'D'
CITIZEN	CLL020, CLL022, CLU024, CLU026, CLU028	13.5	13.5	0.90	11.2
TRIDONIC	SLE G5 LES10	13.5	13.5	0.90	9.4
SEOUL	ZC6	13.5	13.5	0.90	10.0
CITIZEN	CLU025, CLU027	13.5	13.5	0.90	7.4
CITIZEN	CLU700, CLU701	13.5	13.5	0.90	7.8
EVERLIGHT	EAHP1313WA*, EAHP1313WB*, EAHP1313WC*	13.5	13.5	0.90	10.8
EVERLIGHT	EA1313 36V/3W	13.5	13.5	0.90	10.8
EVERLIGHT	EA1313 36V/6W	13.5	13.5	0.90	10.8
EVERLIGHT	EA1313 36V/10W	13.5	13.5	0.90	10.8
EVERLIGHT	EA1313 36V/13W	13.5	13.5	0.90	10.8
VOSSLOH-SCHWABE	DMC122C	13.5	13.5	1.00	10.0
BRIDGELUX	GEN7. V10	13.5	13.5	1.00	10.65

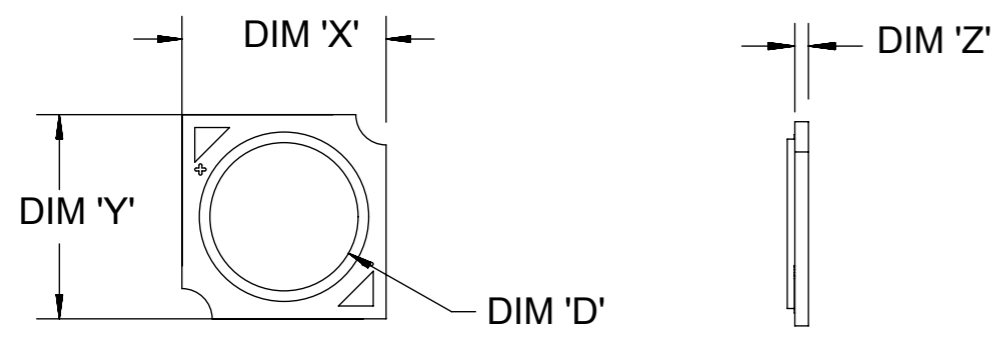

COB LED
SCALE 2:1

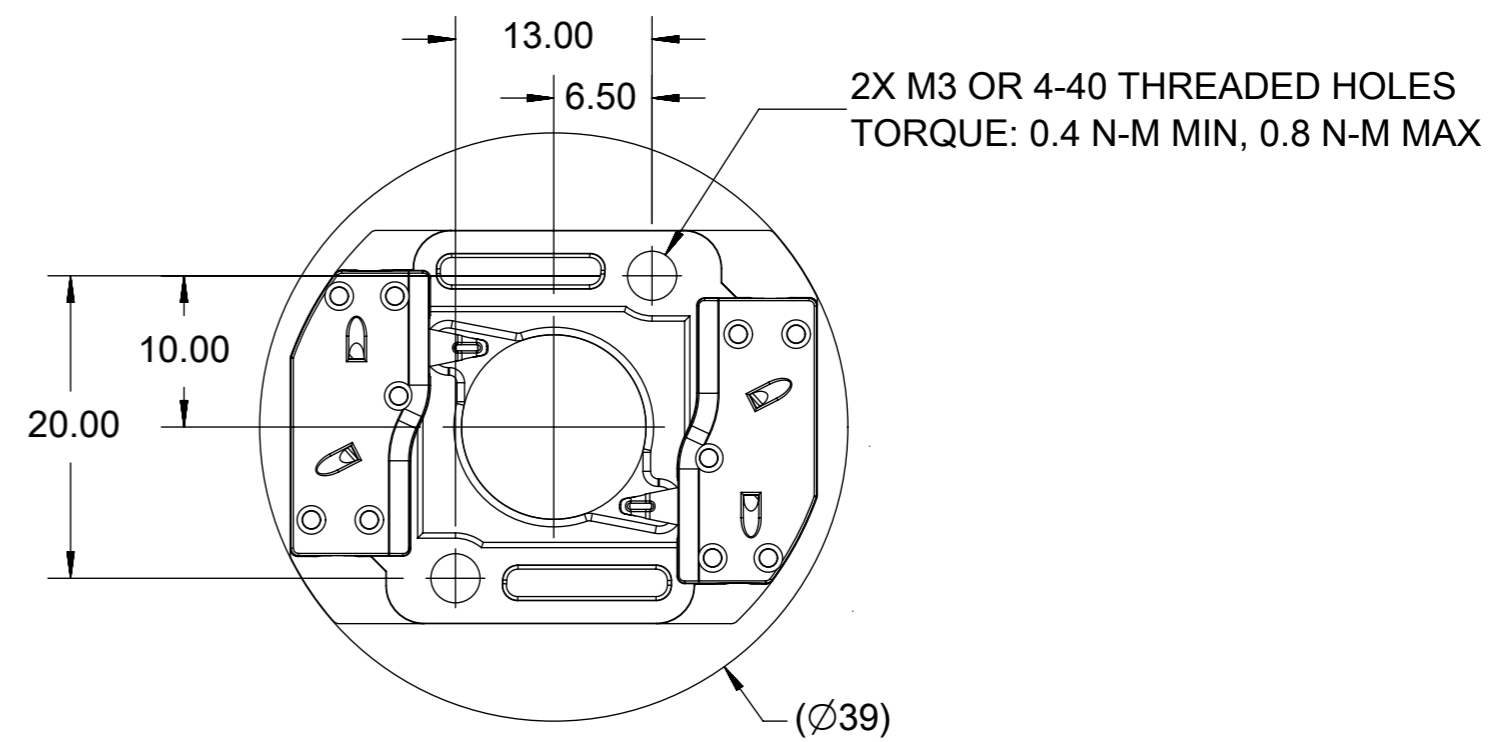

RECOMMENDED MOUNTING DIMENSIONIS

- NOTES:
1. APPLICATION SPECIFICATION: AS-180412-001
 2. FOR USE WITH: 13.5 MM X 13.5 MM COB
 3. WIRE GAUGE: 18, 20 AND 22 AWG, SOLID OR STRANDED WITH TIN OVERCOAT. STRIP LENGTH 10MM +2.0/-0.0MM. RECOMMENDED MAXIMUM DIAMETER AFTER TINNING: 1.40MM. LARGER DIAMETER WIRES ARE ACCEPTABLE IF FULLY INSERTABLE IN WIRE TRAP AND NO WITHDRAWAL WITHIN 20N FORCE.
 4. IF REWORK IS REQUIRED, WIRE MUST BE REPLACED WITH SAME AWG AND TYPE. CARE MUST BE TAKEN NOT TO DAMAGE WIRE TRAP. REWORK IS ACCEPTABLE IF WIRE IS FULLY INSERTABLE IN WIRE TRAP AND NO WITHDRAWAL WITHIN 20N FORCE.

THIS DRAWING CONTAINS INFORMATION THAT IS PROPRIETARY TO MOLEX ELECTRONIC TECHNOLOGIES, LLC AND SHOULD NOT BE USED WITHOUT WRITTEN PERMISSION									
DIMENSION UNITS		SCALE		CURRENT REV DESC:				molex	
mm		1:1							
GENERAL TOLERANCES (UNLESS SPECIFIED)				EC NO: 624787				COB LED HOLDER ASSEMBLY	
ANGULAR TOL ± 0.5°				DRWN: VLOKESHA 2019/05/21				13.5MM X 13.5MM SQUARE	
4 PLACES ±				CHK'D: GGA 2019/11/11				PRODUCT CUSTOMER DRAWING	
3 PLACES ±				APPR: GGA 2019/11/11				DOCUMENT NUMBER	
2 PLACES ± 0.13				INITIAL REVISION:				SD-180414-102	
1 PLACE ± 0.25				DRWN: MCOLE 2012/05/24				DOC TYPE	
0 PLACES ±				APPR: DMCGOWAN 2012/08/06				PSD	
DRAFT WHERE APPLICABLE MUST REMAIN WITHIN DIMENSIONS		THIRD ANGLE PROJECTION		DRAWING		SERIES		REVISION	
		A3-SIZE		180414		MATERIAL NUMBER		C4	
		SEE TABLE		GENERAL MARKET		CUSTOMER		SHEET NUMBER	
								2 OF 2	

10	9	8	7	6	5	4	3	2	1
PART NUMBER	DESCRIPTION	POCKET DEPTH	HOUSING	TERMINAL	CAP				
180414-2112	COB LED HOLDER ASSEMBLY	0.75	180413-2112	180155-0133	180154-0105				

P/N 180414-2112 HOLDER ASSEMBLY (0.75 POCKET DEPTH)

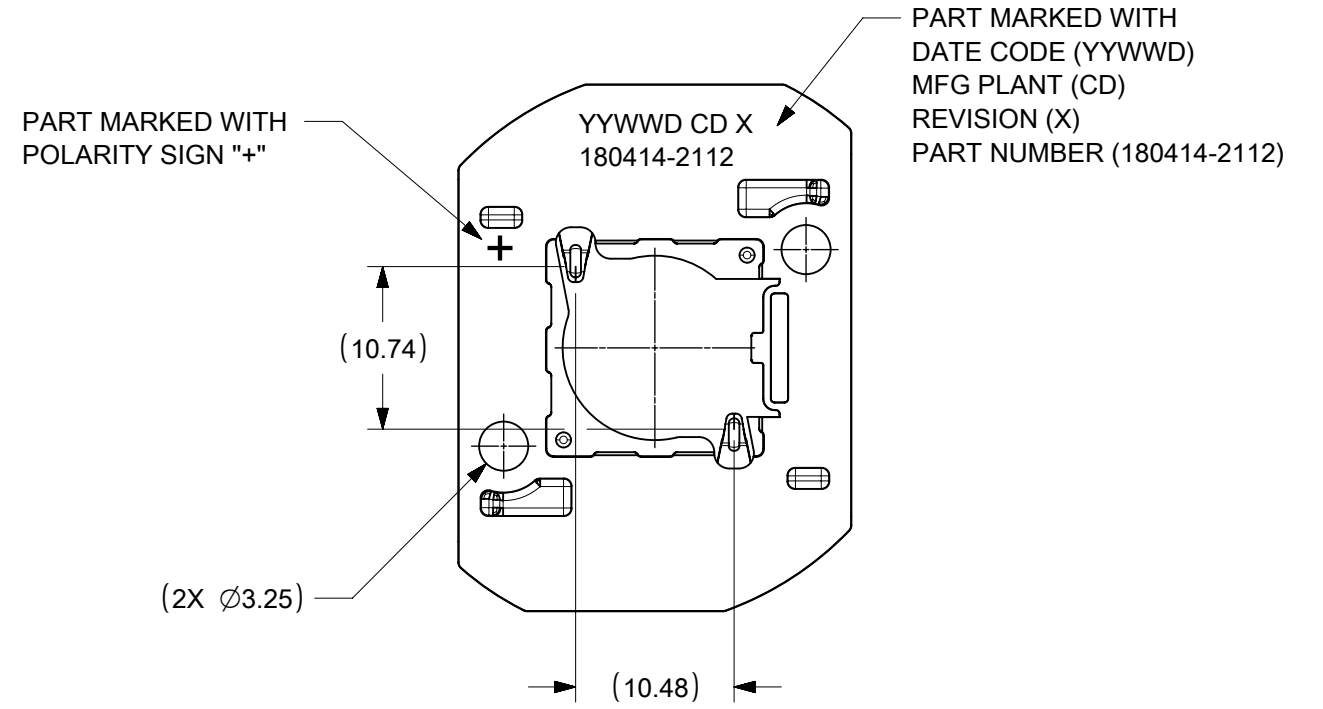
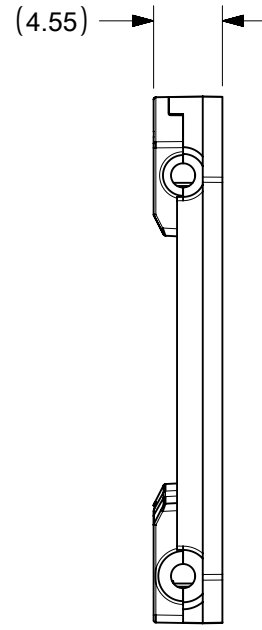
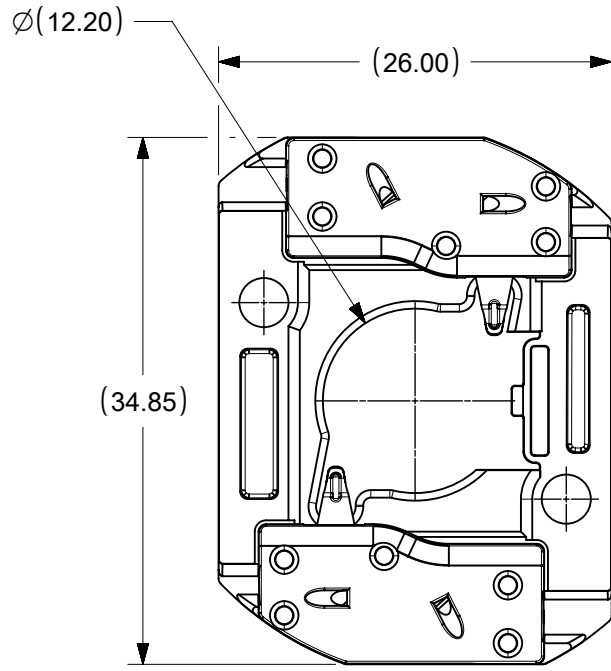

NOTES:

1. MATERIALS: HOUSING AND CAPS: POLYESTER PBT GLASS FILLED; COLOR: WHITE; TERMINAL: COPPER ALLOY
2. FINISHES: TERMINAL CONTACT: SELECT GOLD OVER NICKEL
WIRE TRAP: SELECT TIN OVER NICKEL
3. PRODUCT SPECIFICATION: 180414-0000-PS
4. PACKAGING SPECIFICATION: PK-180419-005
5. UL:OLFB2 UL496 FILE NO. E345583
6. ELV AND ROHS COMPLIANT
7. FOR USE WITH: 13.5 MM X 13.5 MM COB LED
8. WIRE GAUGE: 18, 20, AND 22 AWG, SOLID OR STRANDED WITH TIN OVERCOAT. STRIP LENGTH 10MM +2.0/-0.0MM.
9. ALL DIMENSIONS IN PARENTHESES (XX.XX) ARE FOR REFERENCE ONLY

THIS DRAWING CONTAINS INFORMATION THAT IS PROPRIETARY TO MOLEX ELECTRONIC TECHNOLOGIES, LLC AND SHOULD NOT BE USED WITHOUT WRITTEN PERMISSION									
DIMENSION UNITS		SCALE		CURRENT REV DESC:				molex	
mm		2:1		EC NO: 624787					
GENERAL TOLERANCES (UNLESS SPECIFIED)				DRWN: VLOKESHA		2019/06/13		COB LED HOLDER ASSEMBLY	
4 PLACES		±		CHK'D: GGA		2019/11/11		13.5 MM X 13.5 MM SQUARE	
3 PLACES		±		APPR: GGA		2019/11/11		PRODUCT CUSTOMER DRAWING	
2 PLACES		± 0.13		INITIAL REVISION:				DOCUMENT NUMBER	
1 PLACE		± 0.25		DRWN: MCOLE		2013/12/09		SD-180414-112	
0 PLACES		±		APPR: DMCGOWAN		2013/12/09		DOC TYPE DOC PART REVISION	
ANGULAR TOL		± 0.5°		THIRD ANGLE PROJECTION		DRAWING		PSD 001 C5	
DRAFT WHERE APPLICABLE MUST REMAIN WITHIN DIMENSIONS				SERIES		MATERIAL NUMBER		CUSTOMER	
				B-SIZE		180414		SEE CHART GENERAL MARKET	
				SHEET NUMBER		1 OF 3			

DOCUMENT STATUS	P1	RELEASE DATE	2019/11/11	02:36:40
-----------------	----	--------------	------------	----------

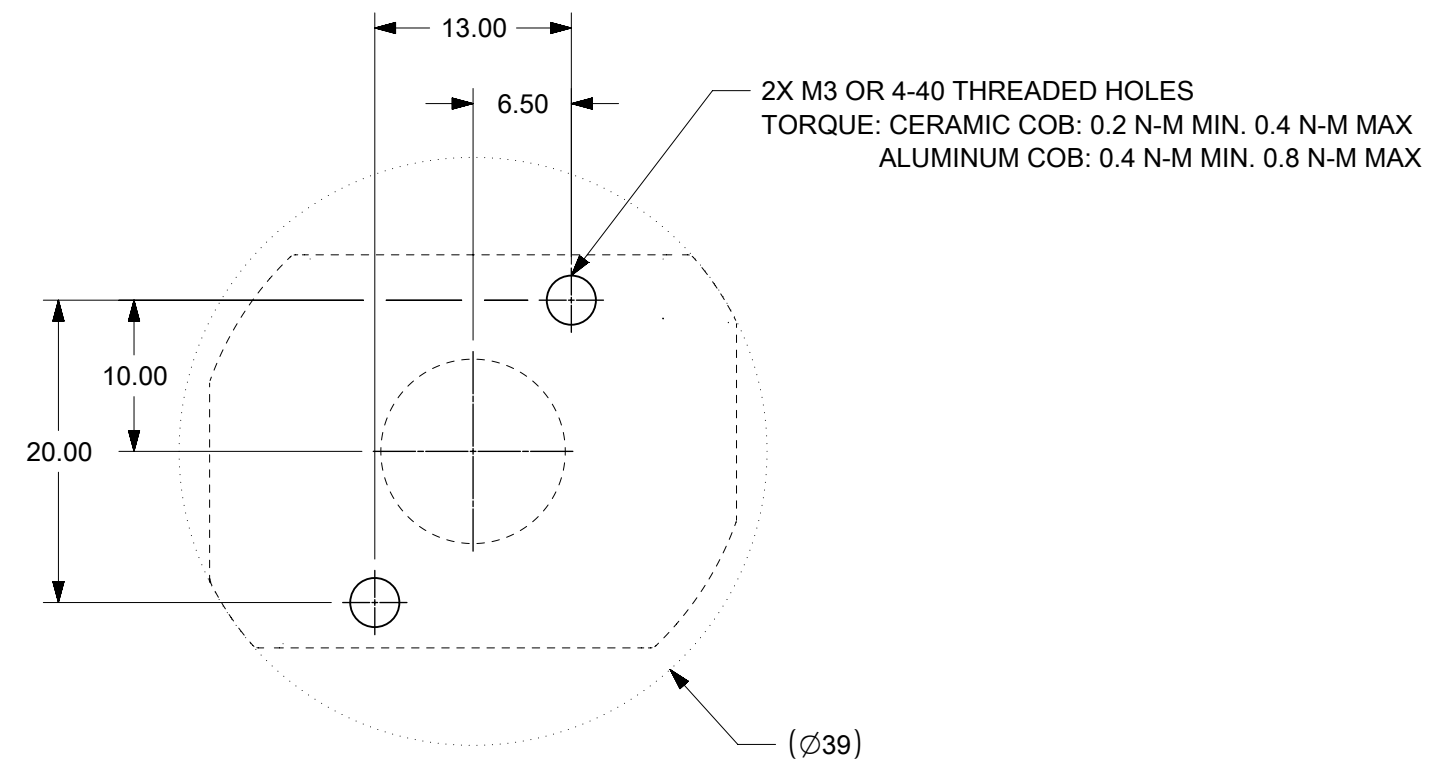

RECOMMENDED MOUNTING DIMENSIONS

THIS DRAWING CONTAINS INFORMATION THAT IS PROPRIETARY TO MOLEX ELECTRONIC TECHNOLOGIES, LLC AND SHOULD NOT BE USED WITHOUT WRITTEN PERMISSION									
DIMENSION UNITS		SCALE		CURRENT REV DESC:				molex	
mm		2:1		EC NO: 624787					
GENERAL TOLERANCES (UNLESS SPECIFIED)				DRWN: VLOKESHA		2019/06/13		COB LED HOLDER ASSEMBLY	
		MM	INCH	CHK'D: GGA		2019/11/11		13.5 MM X 13.5 MM SQUARE	
4 PLACES		±	±	APPR: GGA		2019/11/11		PRODUCT CUSTOMER DRAWING	
3 PLACES		±	±	INITIAL REVISION:				DOCUMENT NUMBER	
2 PLACES		± 0.13	±	DRWN: MCOLE		2013/12/09		SD-180414-112	
1 PLACE		± 0.25	±	APPR: DMCGOWAN		2013/12/09		PSD 001 C5	
0 PLACES		±	±	ANGULAR TOL		± 0.5 °		MATERIAL NUMBER	
DRAFT WHERE APPLICABLE MUST REMAIN WITHIN DIMENSIONS		THIRD ANGLE PROJECTION		DRAWING		SERIES		CUSTOMER	
		B-SIZE		180414		SEE SHEET 1		GENERAL MARKET	
								SHEET NUMBER	
								2 OF 3	

	10	9	8	7	6	5	4	3	2	1
	COB MFG	TYPE			DIM 'X'	DIM 'Y'	DIM 'Z'	DIM 'D'	OFFSET	
F	CITIZEN	CLL020, CLL022, CLU024, CLU026, CLU028			13.5	13.5	0.90	11.2	0.15	
	SEOUL	ZC6			13.5	13.5	0.90	10.0	0.15	
	TRIDONIC	SLE G5 LES10			13.5	13.5	0.90	9.4	0.15	
	CITIZEN	CLU025, CLU027			13.5	13.5	0.90	7.4	0.15	
	CITIZEN	CLU700, CLU701			13.5	13.5	0.90	7.8	0.15	
E	EVERLIGHT	EAHP1313WA*, EAHP1313WB*, EAHP1313WC*			13.5	13.5	0.90	10.8	0.15	
	EVERLIGHT	EA1313 36V/3W			13.5	13.5	0.90	10.8	0.15	
	EVERLIGHT	EA1313 36V/6W			13.5	13.5	0.90	10.8	0.15	
	EVERLIGHT	EA1313 36V/10W			13.5	13.5	0.90	10.8	0.15	
	EVERLIGHT	EA1313 36V/13W			13.5	13.5	0.90	10.8	0.15	
	VOSSLOH-SCHWABE	DMC122C			13.5	13.5	1.00	10.0	0.25	

ILLUSTRATION OF P/N 180414-2112 HOLDER MATED WITH LED

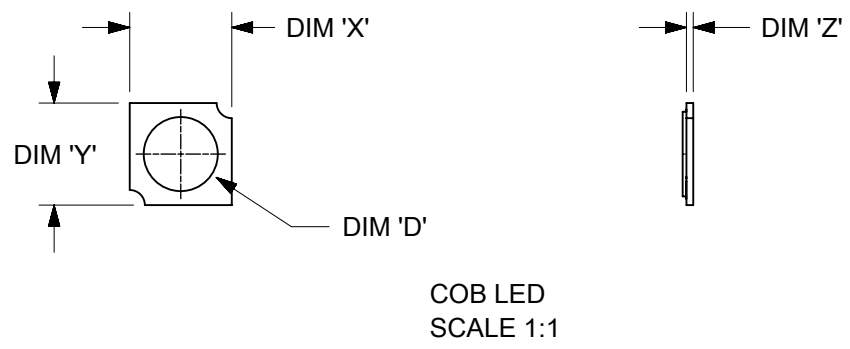
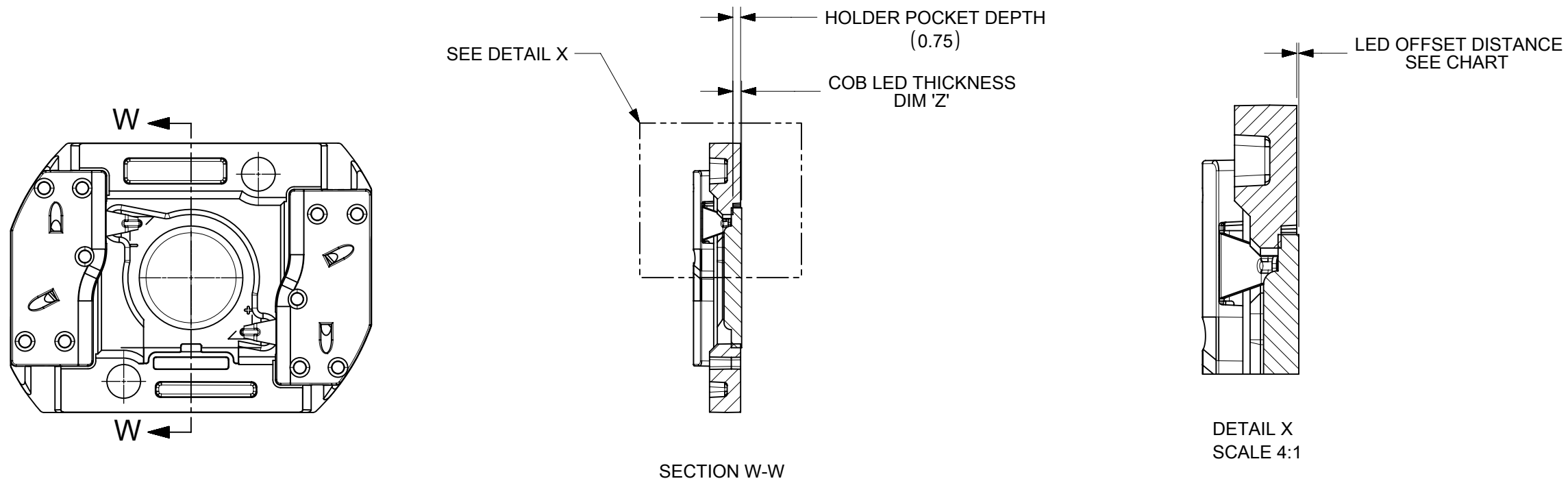

THIS DRAWING CONTAINS INFORMATION THAT IS PROPRIETARY TO MOLEX ELECTRONIC TECHNOLOGIES, LLC AND SHOULD NOT BE USED WITHOUT WRITTEN PERMISSION									
DIMENSION UNITS		SCALE		CURRENT REV DESC:					
mm		2:1		molex COB LED HOLDER ASSEMBLY 13.5 MM X 13.5 MM SQUARE PRODUCT CUSTOMER DRAWING					
GENERAL TOLERANCES (UNLESS SPECIFIED)									
	MM	INCH							
4 PLACES	±								
3 PLACES	±								
2 PLACES	± 0.13			EC NO: 624787	2019/06/13	DOCUMENT NUMBER: SD-180414-112 DOC TYPE: PSD DOC PART: 001 REVISION: C5			
1 PLACE	± 0.25			DRWN: VLOKESHA	2019/11/11				
0 PLACES	±			CHK'D: GGA	2019/11/11				
ANGULAR TOL ± 0.5°				APPR: GGA	2019/11/11	INITIAL REVISION: DRWN: MCOLE 2013/12/09 APPR: DMCGOWAN 2013/12/09			
DRAFT WHERE APPLICABLE MUST REMAIN WITHIN DIMENSIONS				THIRD ANGLE PROJECTION	DRAWING				
					B-SIZE	180414	SEE SHEET 1	GENERAL MARKET	3 OF 3