

TECHNICAL SPECIFICATIONS:
MATERIAL:
HOUSING: LCP GLASS FILLED UL 94-V0, COLOUR BLACK.
TERMINAL: COPPER ALLOY PLATED WITH:
BASE FINISH: NICKEL
CONTACT SURFACE FINISH:
GOLD
OR
GOLD FLASH OVER PALLADIUM NICKEL.
EXCEEDS PRODUCT REQUIREMENTS BASED ON PS-95622-001
SHIELD: COPPER ALLOY PLATED WITH TIN.

NOTES:
1. JACK FOR MATING WITH SHIELDED PLUG
MOLEX 95043 AND 85568 SERIES.
2. PRODUCT SPECIFICATION: MOLEX PS-95622-001.
3. P.C.B. THICKNESS: 1.57
4. PACKAGING SPECIFICATION: SEE CHART. TUBE PACKAGING.
5. APPLICATION SPECIFICATION: AS-85513-001

LAST INSPECTION NO.: 20
REMOVED INSPECTION NO: 3, 18

DOCUMENT STATUS | P1 | RELEASE DATE | 2021/12/16 | 01:29:45

PART NO.	PACKAGING SPEC.
95622-3981	PK-95122-006

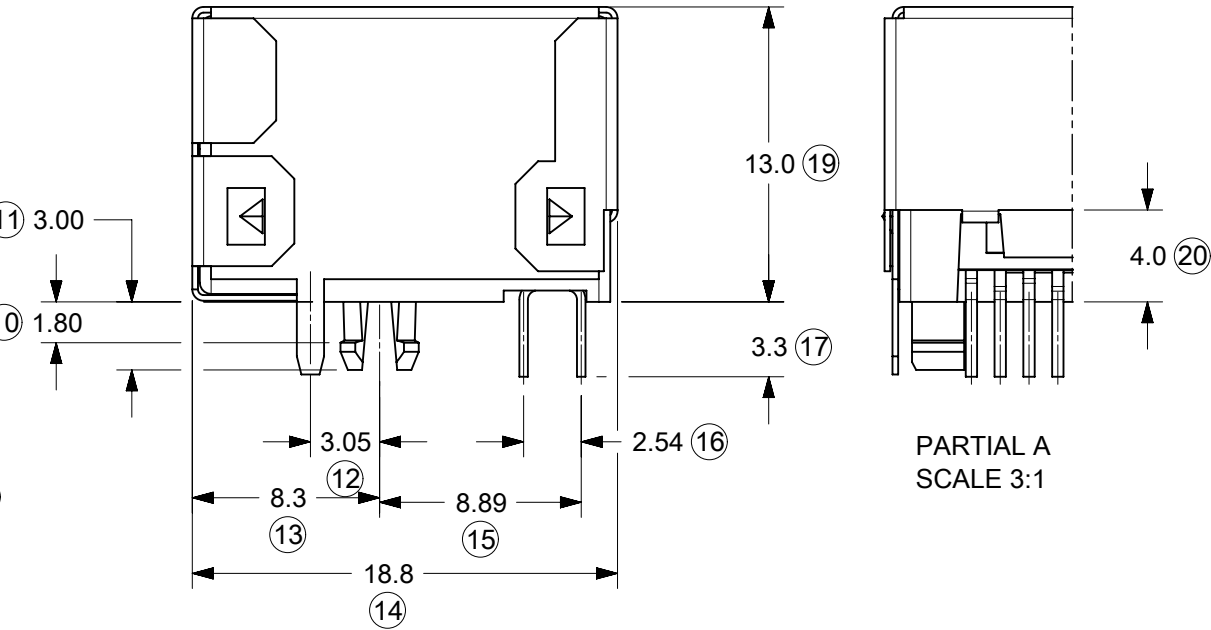
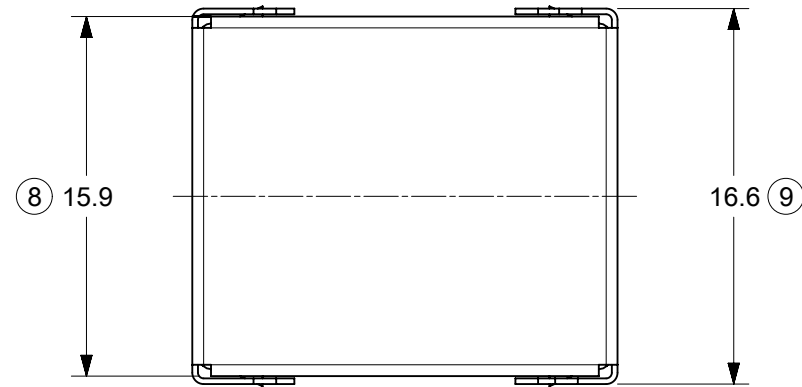
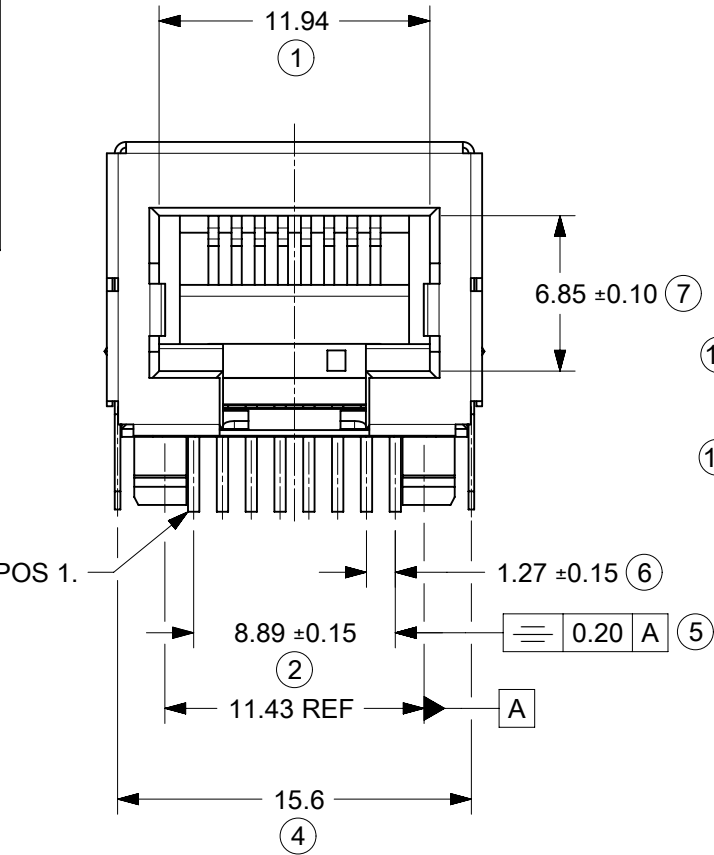

THIS DRAWING CONTAINS INFORMATION THAT IS PROPRIETARY TO MOLEX ELECTRONIC TECHNOLOGIES, LLC AND SHOULD NOT BE USED WITHOUT WRITTEN PERMISSION															
DIMENSION UNITS		SCALE		CURRENT REV DESC: REMASTERED USING 3D MODELS				<div>molex</div>							
mm		3:1													
GENERAL TOLERANCES (UNLESS SPECIFIED)				EC NO: 686748 DRWN: CRAODOREMS 2018/02/09 CHK'D: KLANG 2021/12/16 APPR: KLANG 2021/12/16				FULLY SHIELDED R/A MODULAR JACK 8 CKTS THROUGH HOLE-VERSION LCP							
ANGULAR TOL ± 2.0 °															
4 PLACES		±													
3 PLACES		±													
2 PLACES		± 0.25													
1 PLACE		± 0.35		INITIAL REVISION: DRWN: D.BYRNES 2006/07/27 APPR: EOMAHONY 2006/07/28				PRODUCT CUSTOMER DRAWING							
0 PLACES		±						DOCUMENT NUMBER		DOC TYPE		DOC PART		REVISION	
DRAFT WHERE APPLICABLE MUST REMAIN WITHIN DIMENSIONS				THIRD ANGLE PROJECTION		DRAWING		SERIES		MATERIAL NUMBER		CUSTOMER		SHEET NUMBER	
						A3-SIZE		95622		SEE CHART		GENERAL MARKET		1 OF 1	