

NUMBER OF CONTACTS	"A" Inch (mm)	"B" Inch (mm)	"C" Inch (mm)	"D" Inch (mm)	"E" Inch (mm)
15	1.213 (30.80)	.984 (24.99)	.643 (16.34)	.090 (2.29)	.756 (19.20)
26	1.543 (39.20)	1.312 (33.32)	.972 (24.70)	.090 (2.29)	1.091 (27.70)
44	2.087 (53.00)	1.852 (47.04)	1.512 (38.40)	.090 (2.29)	1.618 (41.10)
62	2.732 (69.40)	2.500 (63.50)	2.157 (54.80)	.095 (2.41)	2.256 (57.30)
78	2.638 (67.00)	2.406 (61.10)	2.055 (52.20)	.095 (2.41)	2.169 (55.10)

NOTE:

MATERIAL HOUSING: PBT UL94V-0, BLACK  
 230°C PROCESS TEMP  
 COPPER ALLOY  
 STEEL

CONTACT: CONTACT: FULL GOLD FLASH  
 SHELL: SHELL: NICKEL

FINISH CONTACT: FULL GOLD FLASH  
 SHELL: NICKEL

ELECTRICAL RATED CURRENT: 5A  
 DWV: 500VAC RMS FOR 1 MIN  
 INSULATOR RESISTANCE: 1000 MΩhms MIN.  
 CONTACT RESISTANCE: 15 mΩhms MAX.

ENVIRONMENT OPERATION TEMPERATURE: -50°C TO +100°C

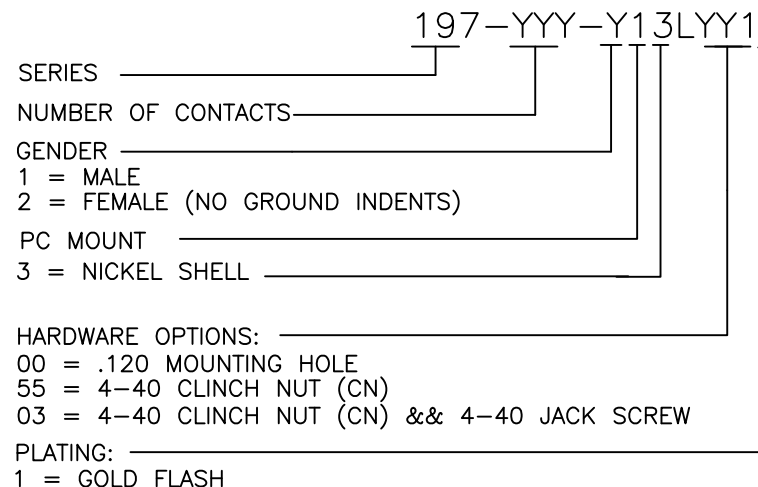
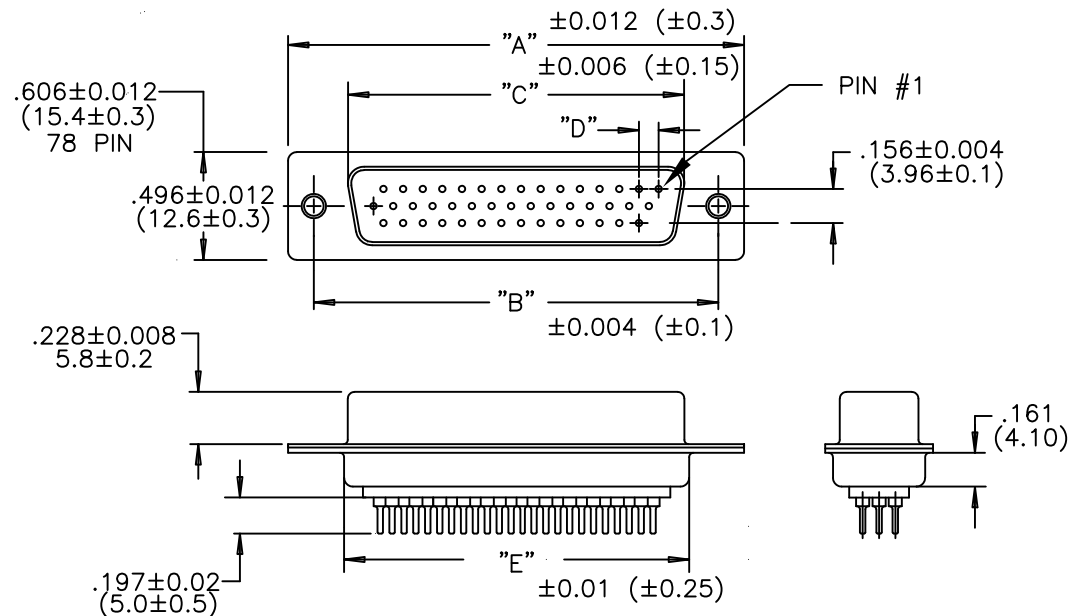

00 ..... THRU HOLE

55 ..... CN

03 ..... CN // JACK SCREW

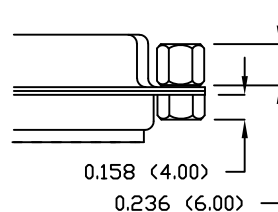
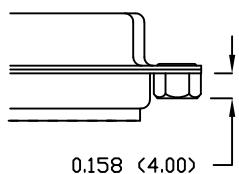
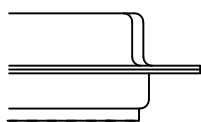

RoHS COMPLIANT

UNITS = inch (mm)

DO NOT SCALE FROM DRAWING



THESE DRAWINGS AND SPECIFICATIONS ARE THE PROPERTY OF NorComp AND SHALL NOT BE REPRODUCED, COPIED OR USED AS THE BASIS FOR THE MANUFACTURE OR SALE OF APPARATUS WITHOUT WRITTEN PERMISSION.

DRAWN:

P. JENKINS

DATE:

09/15/2005

NorComp

SCALE: NTS

SHEET 1 OF 1

REV 4

DWG NO.

197-YYY-213LYY1